

TOTOKU

1.3 Megapixel 17" Color LCD

# CV730X

White : CV730X, Black : CV730X/B

**17"** **Color LCD** **Analog & Digital** **1280 × 1024** **OSD** **Preset Gamma Setting**

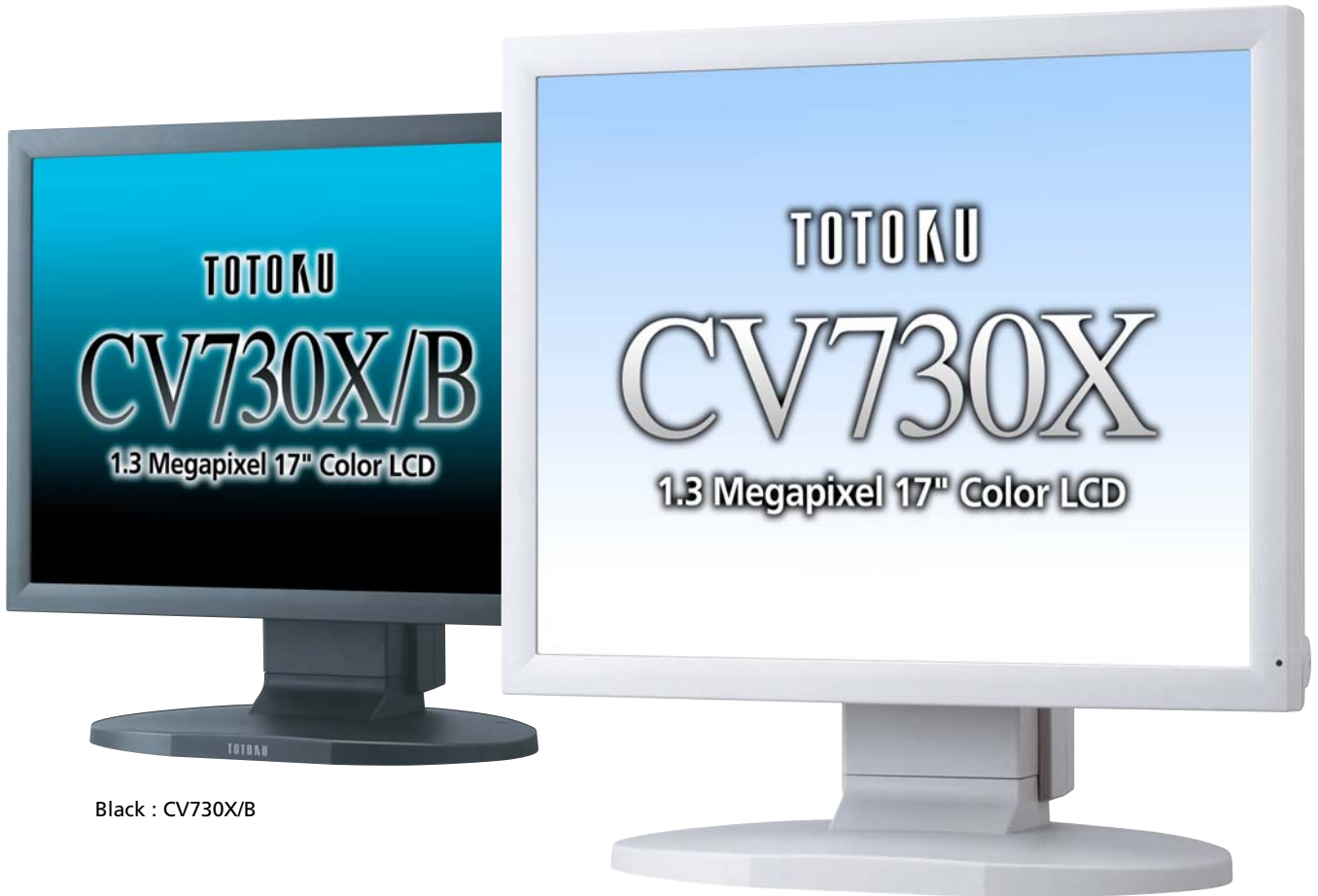

Black : CV730X/B

White : CV730X

**Dual Input - Analog and Digital  
High Performance 17" Color LCD with DICOM Preset**

## Dual Input - Analog and Digital High Performance 17" Color LCD with DICOM Preset



### Selectable Preset Gamma

CV730X has 5 preset gamma settings to choose from, which includes DICOM curve (a standard for medical imaging devices).

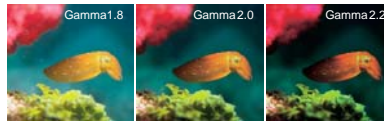

● Difference in vision by gamma settings

### Multi-Functions

- **Dual Interface**  
With both digital (DVI) and analog (analog RGB) interfaces, CV730X offers a wide range of resolution from VGA to SXGA with Plug-&-Play.
- **Auto-Adjust Function**  
The screen size, position, clock and phase can be automatically adjusted with a click of a control dial.
- **Color Temperature Adjustment Function**  
This function offers a range of color temperatures to choose from.
- **Black Level Adjustment Function**  
The black level, a setting that determines the brightness of black on the monitor, is adjustable.
- **Power Management Function**  
CV730X has a power management function, which reduces power consumption to around 2W when put in power management mode.

### Ergonomics Design

- **Control Dial & OSD Adjustment**  
The control dial and OSD allow easy operation.
- **Advanced stand for the best viewing position**  
The supplied stand allows tilt, swivel and landscape/portrait screen rotation.
- **Slim Bezel**  
The slim bezel is perfect for multi-display installations.
- **Choice of Cabinet Color, Black or White**



Model name	CV730X (WHITE)	CV730X/B (BLACK)
LCD Panel	17" TFT color LCD Viewing angle 140° (vertically and horizontally) Contrast 450:1	
Input Signal	Analog: Analog RGB, Digital: DVI	
Resolution	640 X 400 (VGA) ~ 1280 X 1024 (SXGA) pixels	
Color	Full color (16.19 million colors)	
Maximum Luminance	260cd/m <sup>2</sup> (typ.)	
User's Controls (On-screen display controls)	Auto adjustment, Brightness, Contrast, Black level, Size, Position, OSD language, etc. Color preset: Cool, Neutral, Warm, User Gamma preset: DICOM, 1.8, 2.0, 2.2, Neutral	
Safety / EMC Approvals	Safety : UL60950, CSA C22.2 No.950, EMC/CE, IEC60950 EMC : FCC-B, VCCI-B	
Input Power Supply	AC adapter 100-240V 50/60Hz	
Maximum Power Consumption	Approx. 36 W (with Power Management Feature)	
Dimensions (including the tilting base)	Landscape: 378(W) X 395.5(H) X 190(D)mm	
Weight	Approx. 8.3kg	
Tilt Base	Tilt, Swivel, Height adjustment, Portrait / Landscape	
Other Features	VESA Mount (100 X 100mm), Security lock slot	
Accessories	AC adapter, Power cord, User's manual, VGA cable, DVI cable, Windows display setup file	

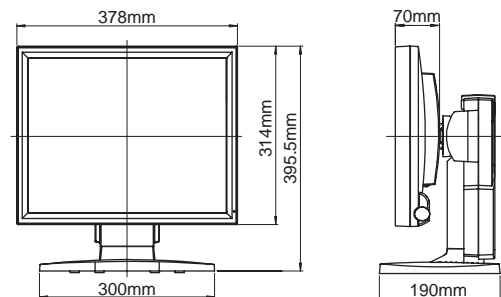

### Safety / EMC Approvals

CV730X has worldwide safety standards and EMC approval.

TOTOKU has obtained ISO14001 and ISO9001/ISO13485 certification which are international standards concerning environment management and quality control respectively.



### Safety Precautions

Please read the user's manual for safe and proper use.

Do not expose the product to dust, moisture, steam, or oily smoke. It could cause fire, electric shock, or a failure.

# TOTOKU

**TOTOKU** Intelligent Devices and Solutions Dept. Sales and Marketing Division.  
TOTOKU ELECTRIC CO., LTD.

1-3-21 Okubo, Shinjuku-ku, Tokyo 169-8543 TEL: +81 3-5273-2022 FAX: +81 3-5273-2091  
\*Osaka Branch: +81 6-6352-3541 \*Nagoya Branch: +81 52-771-1161 \*Shinetsu Branch: +81 268-34-5285

<b>USA</b> TOTOKU NORTH AMERICA, INC 1425 Greenway Dr., Ste. 565 Irving, TX 75038, U.S.A. TEL: +1-972-550-1888 E-mail: info@totoku-na.com	<b>EUROPE</b> TOTOKU ELECTRIC CO., LTD. Jakob-Krebs-Str. 124 D-47877 Willich-Anrath Germany TEL: +49-2156-4918-0 E-mail: info@totoku.de	<b>ASIA</b> TOTOKU ELECTRIC CO., LTD. 3-21, Okubo-1 Chome Shinjuku-ku, Tokyo, Japan TEL: +81-3-5273-2053 E-mail: info-idsc@totoku.co.jp
--	--	--

Additional product information is available at <http://www.totoku.com/display/>

\*Microsoft and Windows are trademarks of the US Microsoft Corporation and are registered in the US and other countries. \*Company names and product names are the trademarks or registered trademarks of the respective companies. \*Product specifications and appearance are subject to change without notice. \*Colors in photographs may differ from actual colors due to the printing process. \*Images on screens are simulated.

Please contact the distributor below with inquiries and orders.