

TOTOKU

1.3 Megapixel 19" Color LCD

CV930X

White : CV930X , Black : CV930X/B



1.3
Megapixel



Black : CV930X/B



White : CV930X

Dual Input - Analog and Digital
High Performance 19" Color LCD with DICOM Preset

Dual Input - Analog and Digital High Performance 19" Color LCD with DICOM Preset

High luminance, high contrast, and wide viewing angle

High image quality is achieved by the high luminance of 300cd/m², high contrast ratio of 1300:1, and a wide viewing angle of 178° horizontally and vertically.

Preset Gamma Settings

CV930X comes with 2 preset gamma settings, including DICOM GSDF, for various use.

Multi-Functions

Dual Interface

With both digital (DVI) and analog (analog RGB) interfaces, CV930X offers a wide range of resolution from VGA to SXGA with Plug-&-Play.

Auto-Adjust Function

The screen size, position, clock and phase can be automatically adjusted with a click of a control dial.

Color Temperature Adjustment Function

This function offers a range of color temperatures to choose from.

Power Management Function

CV930X has a power management function, which reduces power consumption to around 8W when put in power management mode.

Ergonomics Design

Control Dial & OSD Adjustment

The control dial and OSD allow easy operation.

Advanced stand for the best viewing position

The supplied stand allows tilt, swivel and landscape/portrait screen rotation.

Choice of Cabinet Color, Black or White



Safety / EMC Approvals

CV930X has worldwide safety standards and EMC approval.



Model Name	CV930X (White)	CV930X/B (Black)
LCD Panel	Technology	19-inch, TFT Color Active matrix
	Display Area	376.3mm X 301.1mm
	Pixel Pitch	0.294mm X 0.294mm
	Contrast Ratio	1300:1 (Typ.)
	Maximum Luminance	300cd/m ² (Typ.)
Visual Performance	Viewing Angle	178° vertical and horizontal
	Available Resolution	640 X 480 (VGA), ~1280 X 1024 (SXGA)
Input Signal	Color display	Full color (16.77million colors)
	Input Sync Signal	Digital DVI / Analog RGB
Input Power Supply	Plug and Play	DDC2B compliant
	Input	AC adapter 100V ~ 240V (±10%) 50/60Hz
Features	Maximum Power Consumption	60W Typical (with power management feature)
	User's Controls (OSD)	Auto adjustment, Brightness, Contrast, Position, OSD language, etc. Color preset: Cool, Neutral, Warm, User Gamma preset: DICOM, Neutral
Approvals	USB Hub	USB Rev. 2.0 compliant, Self-powered USB upstream connector (x1), USB downstream connector (x2)
	UL60950-1, CSA C22.2 No.950, FCC-B, VCC-B, LVD/EMC/CE	
Physical Characteristics	Dimensions (incl. tilt stand)	Landscape : 432 (W) X 434 / 495.5 (H) X 220.0 (D) mm Portrait : 353 (W) X 474 / 535.4 (H) X 220.0 (D) mm
	Weight	Net: approx. 10kg, Without tilstand: approx. 5.9kg
	Tilt stand	Tilt, Swivel, Portrait / Landscape
	Mount	100mm VESA mounting
	Security Slot	Antitheft security slot (Panel and tilt stand)
Accessories	AC adapter, Power cord, VGA cable, DVI cable, Windows display setup file, Operation manual	

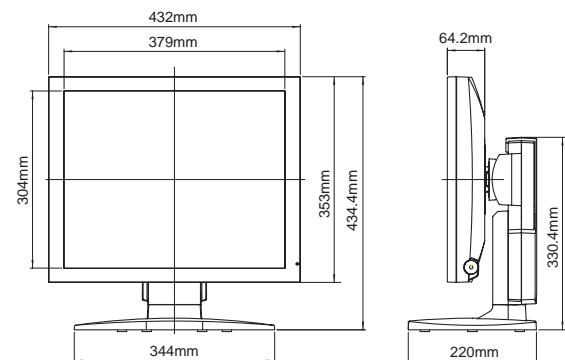

TOTOKU has obtained ISO14001 and ISO9001/ISO13485 certification which are international standards concerning environment management and quality control respectively.

TOTOKU

TOTOKU Intelligent Devices and Solutions Dept. Sales and Marketing Division.
TOTOKU ELECTRIC CO., LTD.

1-3-21 Okubo, Shinjuku-ku, Tokyo 169-8543 TEL: +81 3-5273-2022 FAX: +81 3-5273-2091
*Osaka Branch: +81 6-6352-3541 *Nagoya Branch: +81 52-771-1161 *Shinetsu Branch: +81 268-34-5285

USA
TOTOKU NORTH AMERICA, INC
1425 Greenway Dr., Ste. 565
Irving, Tx 75038, U.S.A.
TEL : +1-972-550-1888
E-mail : info@totoku-na.com

EUROPE
TOTOKU ELECTRIC CO., LTD.
Jakob-Krebs-Str. 124
D-47877 Willich-Anrath Germany
TEL : +49-2156-4918-0
E-mail : info@totoku.de

ASIA
TOTOKU ELECTRIC CO., LTD.
3-21, Okubo-1 Chome
Shinjuku-ku, Tokyo, Japan
TEL : +81-3-5273-2053
E-mail : info-idsc@totoku.co.jp

Additional product information is available at <http://www.totoku.com/display/>

*Microsoft and Windows are trademarks of the US Microsoft Corporation and are registered in the US and other countries. *Company names and product names are the trademarks or registered trademarks of the respective companies. *Product specifications and appearance are subject to change without notice. *Colors in photographs may differ from actual colors due to the printing process. *Images on screens are simulated.

Please contact the distributor below with inquiries and orders.